

3 Apply the sear on the rails like in the images below. Make a cut out for the vehicle beams.



1 Clean rails and corresponding roof surface with SIKA Cleaner P.



2 Prime rail and corresponding roof surface. Wait 10 minutes for the primer to dry.



Primer Dry time (can be applied between 5° to 40°)
Above 15° 10 min
Below 15° 30 min

4 Apply glue (Sikaflex 668) to the first rail and fit it to the section previously primed. Repeat for the second rail.

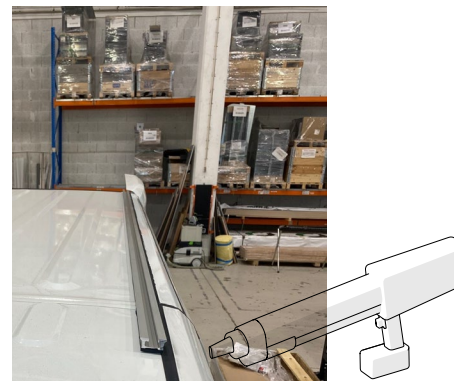

5 Mount the end caps on the front part of the roof rails.



SAFETY GEAR



SAFETY GEAR



SAFETY GEAR



Roof bar kit Maxus e-Deliver, 3 bars



RR73003530

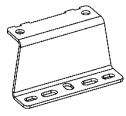

6x 62883

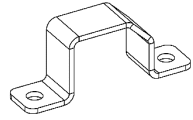

6x R6283



3x 73212



2x RR73000030

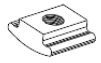

12x M8



16x M8x16



12x M8



12.5m R66652



2x 37000



= 11 kg

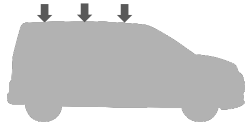
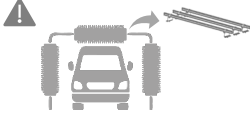

6



M8x16



M8



20Nm



7



M8x16



M8

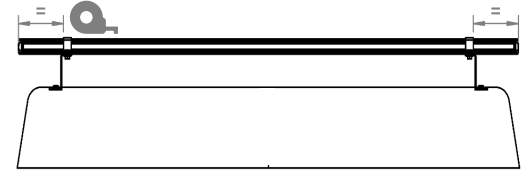
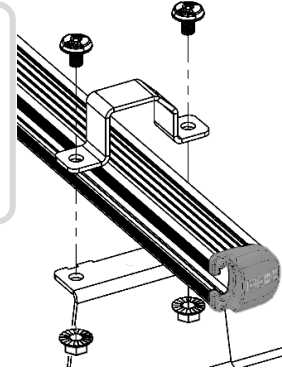

20Nm

